

# EEx de slip ring unit body

## Type ACS-300 and ACS-300T with center tube

### Application

The ACS-300 slip ring unit is basically used for larger sized offshore cranes when there is need for a transfer of medium power and signals. It has also been installed on cranes driven by diesel machinery and cable reels. The ACS-300(T) is normally equipped with two integrated EEx e junction on both ring and brush side.

All EEx e junction boxes can be provided with the required number and sizes of EEx e cable glands or predrilled holes for these or Multi cable Transit (MCT).

The junction boxes vary in size according to number/size of terminals and to give good space for customer's cables.

All ACS-300 units are arranged with rings and brushes according to customer specifications. The ACS-300 units are furnished with self-regulated anti condensation heater as standard. The units can be mounted both horizontally and vertically.

The mounting flange is located on the brush side.

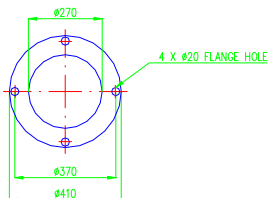
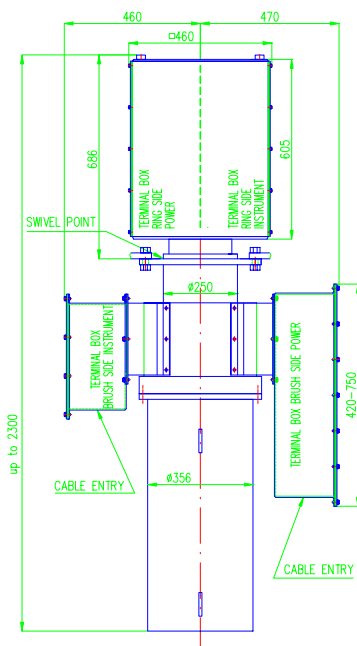

### Technical Characteristics of ACS-300(T)

Ex-Code:	II 2 G EEx de IIB T6/T4
Certificate	Nemko 03ATEX1398
Configuration:	Customized
Max. Current:	3+PE/100A at 3,3kV or 12+PE/210A at 690VAC
Max. Voltage	3300V
IP-grade	IP 66
Rings:	Brass, Copper / Silver plated copper
Brushes:	Copper graphite / Silver graphite
Cable entries:	EEx e cable glands or Multi Cable Transits (MCT)
Housing:	Painted steel or stainless steel
Painting:	According to Norsok offshore standard
Junction boxes:	Brush side: 2 pcs. up to 41x68x20cm steel or AISI 316L Ring side: 2 pcs. up to 45x45x59cm
Option:	Center tube for air/hydraulic or fiber optic swivel, $\varnothing 32/20$ standard, available up to $\varnothing 85/75$ mm.
Heater:	Standard 230VAC/~100W, other types available on request
Weight:	Approx. 250-400 kg

